

PMC-1428S



PMC-1428S

Standard SMD Reed Switch

Electrical Characteristics @ 25 °C

Contact form		A
Contact material		PGM*
Contact rating max.	W / VA	10
Switching voltage max.	VDC	100
	VAC	100
Switching current max.	A	0.5
Carry current max.	A	1
Breakdown voltage min.	VDC	150
Contact resistance max. (initial)	mΩ	100
Insulation resistance min.	Ω	10 ⁹

*PGM = Platinum Group Metal

Magnetical Characteristics (of unmodified Reed Switch) @ 25 °C

Pull in range available	AT	10 - 35
Drop out min.	AT	5
Test coil	TC	086
Test equipment tolerance	± AT	2

Operating Characteristics @ 25 °C

Switching frequency max.	Hz	500
Resonant frequency typ.	Hz	5000
Operate time max. (incl. bounce)	ms	0.4
Release time max.	ms	0.05

Environmental Characteristics

Operating temperature	°C	-55 to +125
Storage temperature	°C	-55 to +125
Soldering temperature max.	°C	300
Vibration (50-2000 Hz)	g	20
Shock (1/2 sin 11 ms)	g	30
Lead tensile strength min.	kg	4.5

Features

- Small size
- Minimum height above PCB
- Over 1 billion reliable operations at dry circuits or low level loads
- Perfect economical alternative to Hall switches
- Suitable for automated assembly
- Tape & reel packaging
- Various sensitivity ranges available

Approvals

RoHS

REACH

UL US

Dimensions in mm

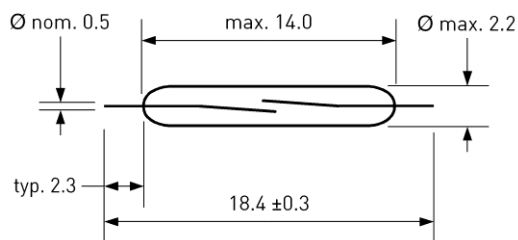

Ordering Information

Packing Unit	5000 pcs
Weight per piece	0.1 g
Weight per package	900 g
Reel size	13 inches
Standard AT ranges	

10 to 15 AT
15 to 20 AT
20 to 25 AT
25 to 30 AT
30 to 35 AT

Ordering example

PMC1428S1520 describes
PMC1428S with 15 to 20 AT.

PMC-1428S



PMC-1428S
Standard SMD Reed Switch

Recommended PCB Layout in mm

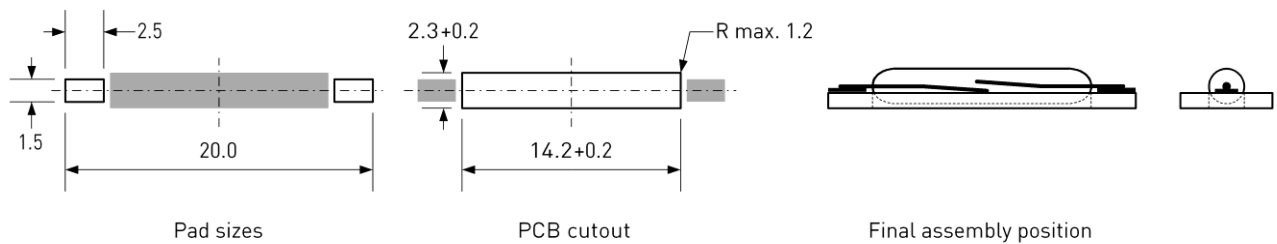

Soldering Information

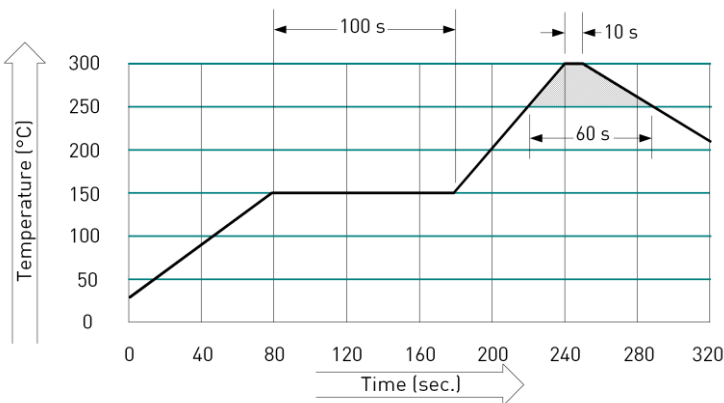

Mounting Force

Recommended Mounting Force	3 N
Maximum Mounting Force	8 N

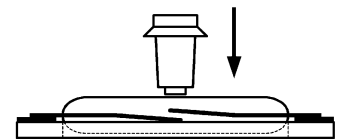

Tape Dimensions in mm

Tolerance ± 0.1 unless otherwise specified

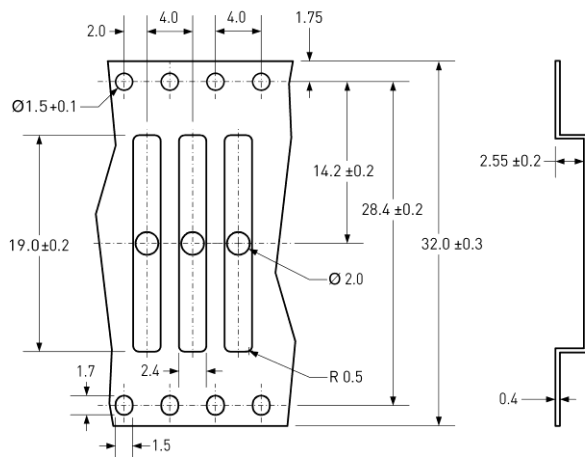

Remarks

When placed onto ferromagnetic parts switching distance of PMC-1428S may reduce.

Electromagnetical influences and magnetic fields may change the switching behaviour of the SMD Reed Switch.